

REV.	DESCRIPTION	DATE
A	RELEASE	Sep.09, 2010
B	N15'03011	Mar.20, 2015
C	N18'09006	Sep.29, 2018

### MATERIALS

- HOUSING : THERMOPLASTIC (UL 94V-0).
- TERMINAL : COPPER ALLOY, GOLD PLATED ON CONTACT AREA, GOLD PLATED ON TAIL.
- SHELL : COPPER ALLOY, NICKEL PLATED OVERALL.

### SPECIFICATION

- CURRENT RATING : 0.5 A. MAX.
- DIELECTRIC WITHSTANDING VOLTAGE : 500V AC R.M.S. FOR ONE MINUTE.
- INSULATION RESISTANCE :  $1000M\ \mu+2126$  MIN. AT 500V DC.
- CONTACT RESISTANCE :  $30M\ \mu+2126$  MAX.
- OPERATING TEMPERATURE : -25°C TO +85°C.

### PART NUMBER INFORMATION:

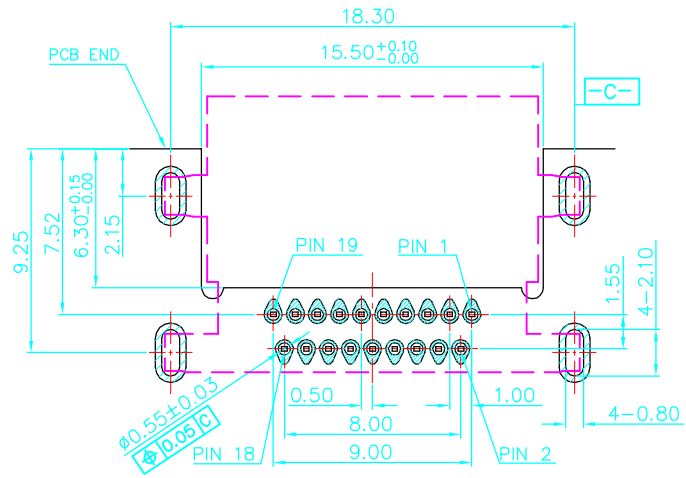
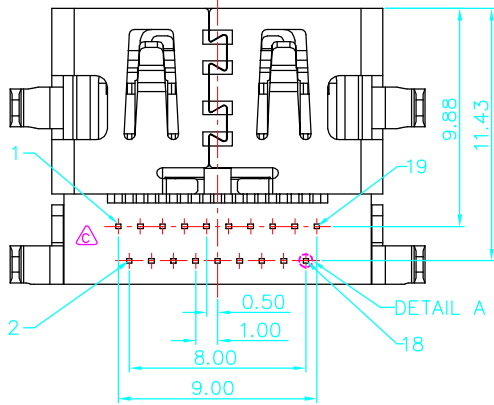
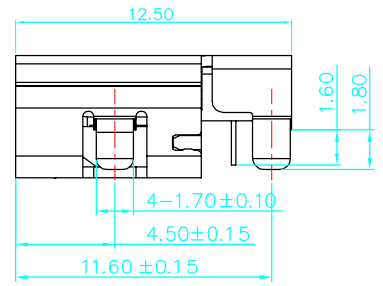
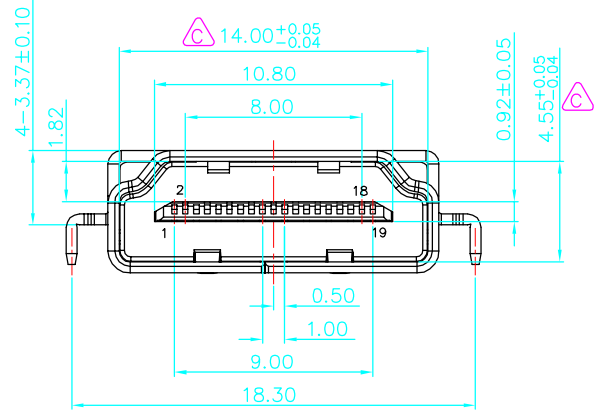
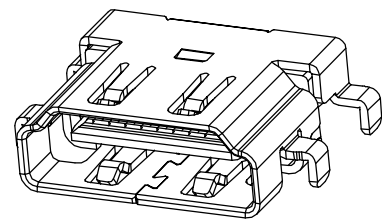
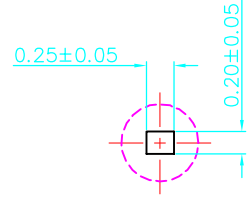
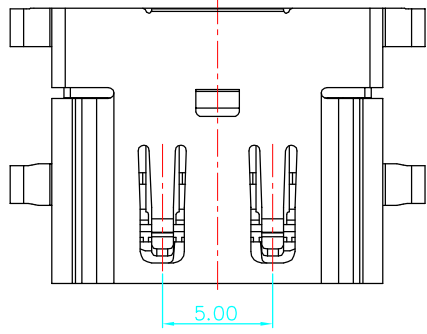
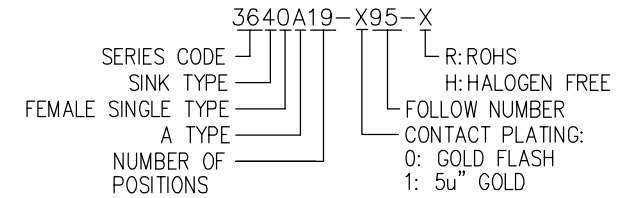

RECOMMENDED P.C.B LAYOUT  
(TOLERANCE=±0.03mm)  
(TOP VIEW)

PIN	SIGNAL ASSIGNMENT	PIN	SIGNAL ASSIGNMENT	PIN	SIGNAL ASSIGNMENT
1	TMDS Data2+	8	TMDS Data0 Shield	15	SCL
2	TMDS Data2 Shield	9	TMDS Data0 -	16	SDA
3	TMDS Data2-	10	TMDS Clock+	17	DDC/CEC Ground
4	TMDS Data1+	11	TMDS Clock Shield	18	+5V Power
5	TMDS Data1 Shield	12	TMDS Clock-	19	Hot Plug Detect
6	TMDS Data1-	13	CEC		
7	TMDS Data0+	14	Reserved (N.C. on device)		

TOLERANCE .0=±0.38 .00=±0.25 .000=±0.10 ANG.=±3°		DRAWER Chen		 ASTRON TECHNOLOGY CORP. NAME HDMI TYPE A FEMALE REVERSE DIP TYPE DRAW NO. R3640A19-X95-X
UNITS : mm		CHECK Stony		
SCALE NONE SIZE A4		APP'D Stony		
SHEET 1 OF 1 REV. C		PRODUCT SPEC.		